

WS Series Electric Pallet Truck With Lithium Battery Specification

		HANGCHA GROUP CO.,LTD.						
		Model	CBD18-WS-SE	CBD20-WS-SE	CBD15-WS	CBD15-WS-65L	CBD20-WS	
Characteristics	1.1 Capacity	kg	1800	2000	1500	1500	2000	
	1.2 Load centre distance	mm	600	600	600	600	600	
	1.3 Standard overall fork width	mm	550/685	550/685	520/550/685	550/685	550/685	
	1.4 Fork length	mm	1150/1220	1150/1220	1150/1220	1150/1220	1150/1220	
	1.5 Overall length	mm	1552/1622	1552/1622	1552/1622	1552/1622	1552/1622	
	1.6 Wheelbase	mm	1197/1267	1197/1267	1197/1267	1197/1267	1197/1267	
	1.7 Lowered height of fork	mm	82±2	82±2	82±2	65±2	82±2	
	1.8 MAX height of fork	mm	197	197	197	165	197	
	1.9 Overall length (with tiller)	mm	1300	1300	1250	1250	1250	
	1.10 Rear body width	mm	550/685	550/685	520/550/685	550/685	550/685	
	1.11 Minimum turning radius	mm	1353/1426	1353/1426	1353/1426	1353/1426	1353/1426	
Performance	2.1 Max.Traveling speed	laden	km/h	4	4	4	4	4
		unladen	km/h	4.5	4.5	4.5	4.5	4.5
	2.2 Gradeability	laden	%	6	6	6	6	6
		unladen	%	20	20	20	20	20
	2.3 Traveling	kW	DC 0.75 Brushless	DC 1.0 Brushless	DC 0.75 Brushless	DC 0.75 Brushless	DC 1.0 Brushless	
	2.4 Lifting	kW	Hydraulic	Hydraulic	DC 0.8	DC 0.8	DC 0.8	
2.5 Lifting speed, laden/unladen	mm/s	/	/	18/23	18/23	18/23		
2.6 Lowering speed, laden/unladen	mm/s	/	/	56/46	56/46	56/46		
Battery	4.1 Voltage	V	48	48	48	48	48	
	4.2 Capacity/type	Ah	10Ah Lithium	10Ah Lithium	10Ah Lithium	10Ah Lithium	10Ah Lithium	
Brake type	5.1 Travel brake		Regenerate	Regenerate	Regenerate	Regenerate	Regenerate	
	5.2 Brake		Electromagnetic	Electromagnetic	Electromagnetic	Electromagnetic	Electromagnetic	
Controller	6.1 Controller		B1503	B1503	B1503	B1503	B1503	

- 520mm fork width: only for CBD15-WS model.
- Short fork length: 800mm/900mm/1000mm.
- Long fork length: 1300mm/1500mm(only for CBD15-WS model).
- 65 low profile: only two sizes can be produced: 550*1150mm/685*1220mm.
- 75 Low Profile: for CBD15-WS and CBD20-WS, with the combination lock handle.
- Battery: 1.5T with 10Ah lithium battery standard, 2.0T with 10Ah lithium battery standard.

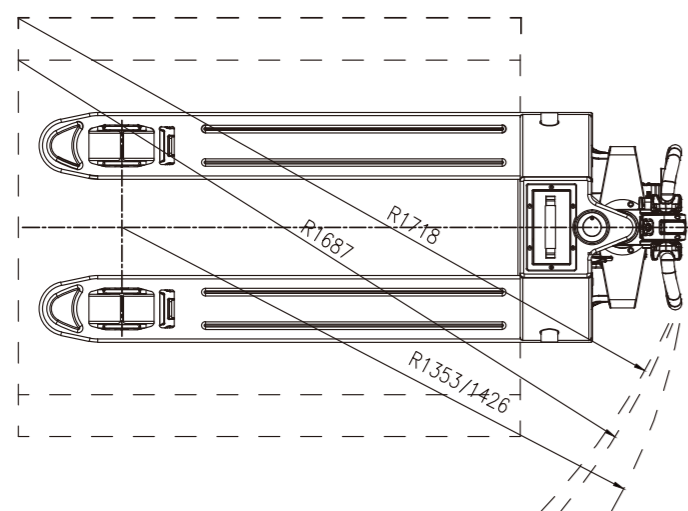
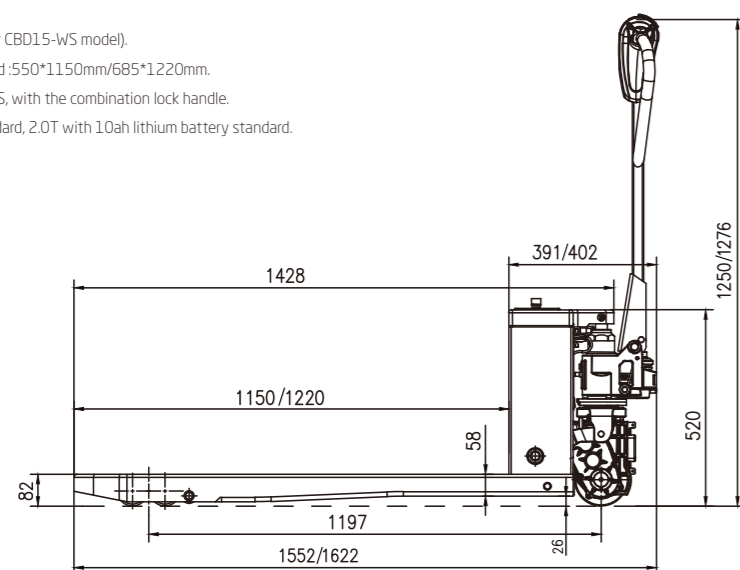

Hangcha Europe GmbH

Mariechen-Graulich-Straße 12a,
65439 Flörsheim am Main,
Germany

Administration
Tel: 0049-61453769188
E-mail: admin@hangchaeurope.com

Sales Management
Thomas Dittrich
Mob: 0049-16096548808
E-mail: thomas.dittrich@hangchaeurope.com

Technical Support
Thomas Pannke
Mob: 0049-01759284213
E-mail: thomas.pannke@hangchaeurope.com

www.hangchaeurope.com



HANGCHA Group Co, LTD behält sich das Recht vor, Änderungen bezgl. Farbe, Spezifikationen, Ausstattung und sonstige Details, dieser Broschüre ohne Vorankündigung vorzunehmen. Fahrzeugfarben können von den Farben in dieser Broschüre abweichen.



WS Series Electric Pallet Truck With Lithium Battery

with capacities of 1,500/1,800/2,000kg

The World of Hangcha
SINCE 1956



PERFORMANCE

Traveling speed
 — UNLADEN 4.5Km/h
 + LADEN 4Km/h

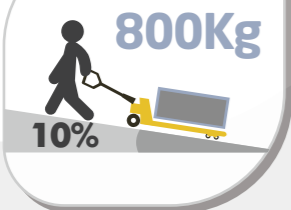
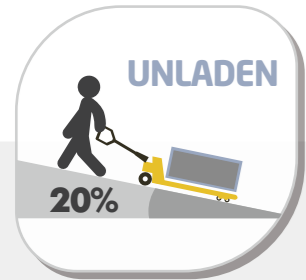

Gradeability

SMART FUNCTION

SMART FUNCTION 01

Turtle Speed
 Horn Remains Pressed & Forward 2 times

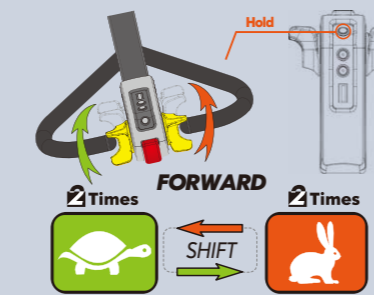

SMART FUNCTION 02

Up-Right Drive
 Reverse Button & Forward Throttle Remain Pressed, Power On

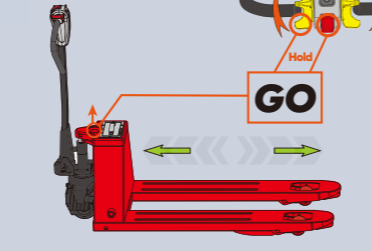

SMART FUNCTION 03

Engineering Mode (Brake Release)
 Horn Remains Pressed, Power On

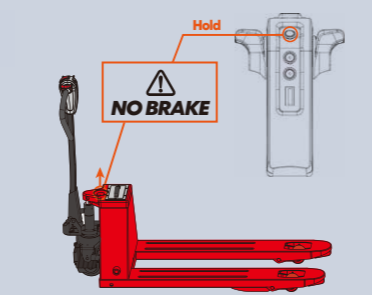

⚠ In up-right drive mode, vehicle will move when handle is operated at any position. Please avoid misoperation.
 ⚠ Brake release mode is only for emergencies, not allowed for vehicle with normal conditions.

CHARACTERISTICS

■ 75mm Lowered height of fork

- Recharge alert
- Hour meter
- Powered traveling
- Powered lifting & lowering
- Error code display
- PIN access control
- Emergency stop button
- Horn

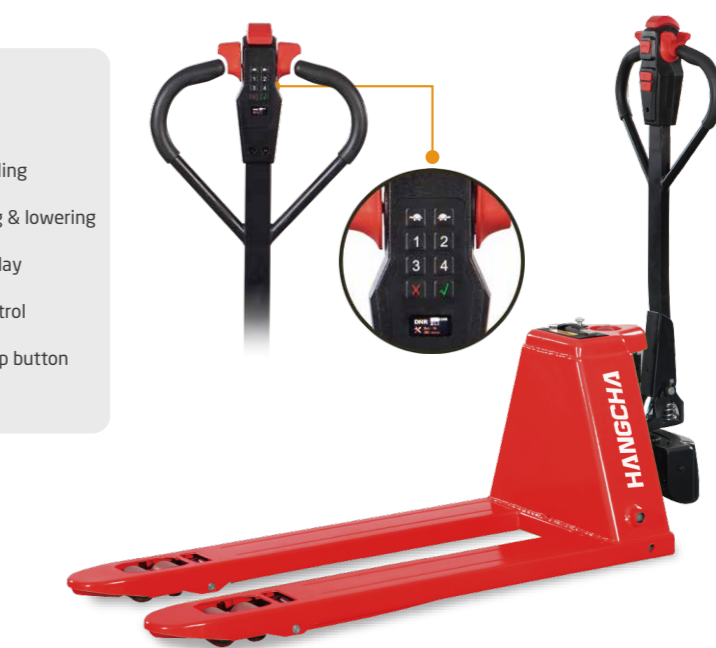

■ 65mm/82mm Lowered height of fork



- Emergency reverse button
- Horn
- Forward/reverse butterfly switch
- Lifting / Lowering
- LCD Screen
 - Battery indicator with hour meter
 - Error code display
 - Recharge Alert

- Multi-function Handle (Full Electric)
- Multi-function Ergonomic Handle (Semi-electric)

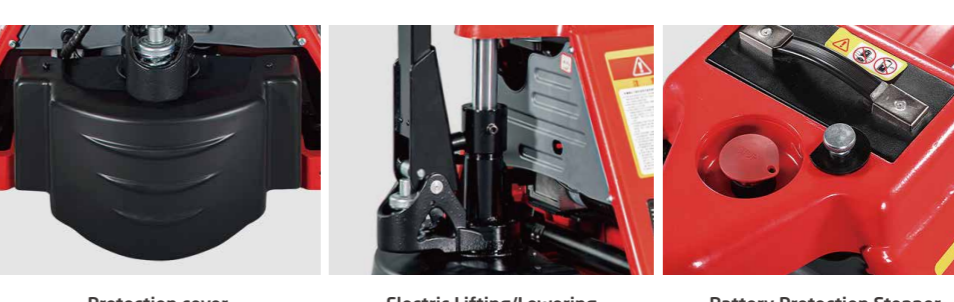

BUILT TO WORK
24
 HOURS

SMART SIZE ALMOST SAME

LIGHT WEIGHT

ELECTRIC PALLET TRUCK ONLY 125kgs
 HAND PALLET TRUCK 80 kgs

EFFICIENCY
 3 Times Higher Than Manual Pallet Truck

EASY MAINTENANCE

LIFETIME
 3 Times Longer Than Manual Pallet Truck

PAY A LITTLE MORE SAVE MUCH MORE

MAINTENANCE SO EASY



5 YEAR WARRANTY CHASSIS

- Brushless drive motor, maintenance free
- Lithium-ion Lithium battery maintenance free
- Recharge Alert
- Error code display
- 6s Replace Battery
- 60s Replace Drive Wheel

OPTIONS



Tandem/Single PU wheel



15Ah Lithium Battery



Fast Charger 2hrs



Intelligent Control Key



Low profile forks
 Lowered fork height: 65mm
 Standard model: 82mm